

TECTUS

- Used in door frames made out of hollow metal or wood in flush interior doors
- Maintenance-free slide bearings
- Suitable for left and right hand applications
- UL listed for 20 minute rated fire doors (maximum door size: 4' x 8' for a single door, 8' x 8' for a pair of doors)

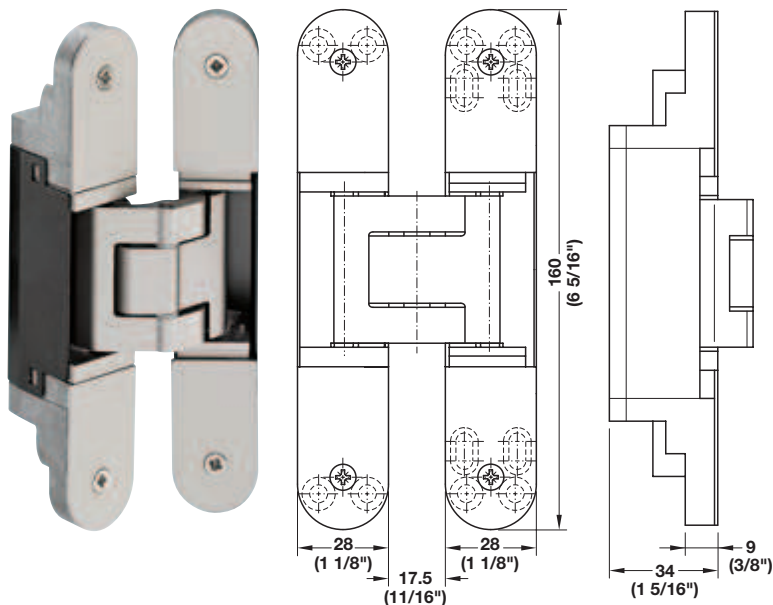

TE 340 3D

- Door weight: ≤ 80 kg (176 lbs.)
- Door thickness: ≥ 40 mm (1 9/16")
- Opening angle: $\leq 180^\circ$
- Router bit \varnothing : 24 mm (15/16")
- Router guide \varnothing : 30 mm (1 3/16")
- Adjustment: three-dimensionally adjustable:
Height and Width: ± 3 mm (1/8")
Depth: ± 1.0 mm (1/16")

Material: Aluminum Die-cast

Finish	Item No.
stainless steel effect	924.17.104
satin chrome colored	924.17.121
satin nickel colored	924.17.122
black powder-coated	924.17.137
bronze powder-coated (US10B look)	924.17.150
rustic umber colored	924.17.116
satin nickel-plated	924.17.171
polished nickel-plated	924.17.170
polished brass-plated	924.17.169
white powder-coated RAL 9016	924.17.177
dark bronze	924.17.152

Mounting

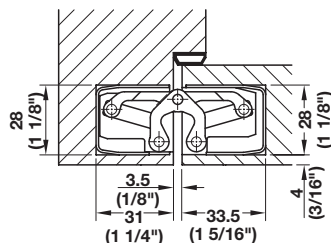

Mounted to a wood door frame

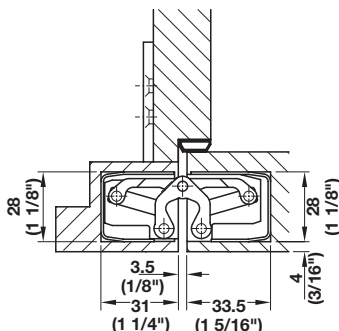

Mounted to a wood door jamb together with a mounting plate

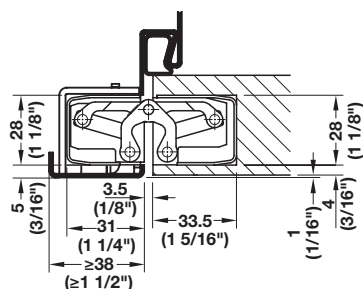

Mounted to a hollow metal frame with a receiver element

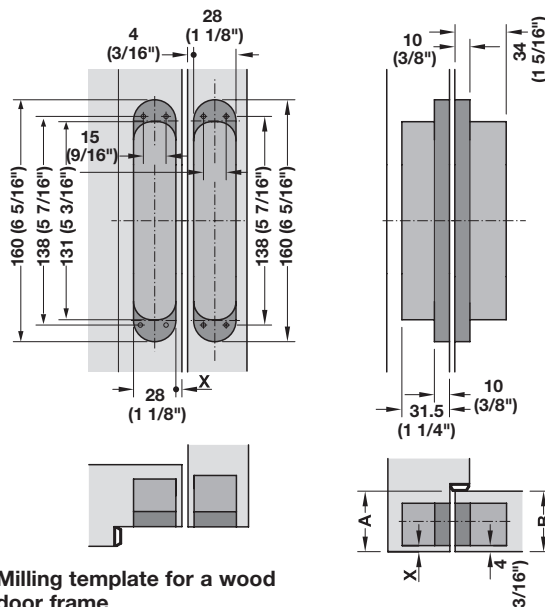

Milling template for a wood door frame

Calculation of the milling dimensions:

A = Rabbet depth excluding seal clearance

B = Door thickness

A - B + 3 = Dimension X

The result has to fall between 3 mm (1/8") and maximum 5 mm (3/16").

For hollow metal frame applications X = 5 mm (3/16")

Mounting plates page 4.25

Receiving elements page 4.26

Dimensions in mm
Inches are approximate